

ESE Direct
Wensum Works
150 Northumberland Street
Norwich
NR2 4EE

(01603) 629956
sales@eseprojects.co.uk

GUIDE RAILS

Information Sheet

PRODUCT

Guide Rail systems are used to control forklift truck movement in racking environments whilst maximising the travel speeds possible. They are commonly used where space is at a premium and gangway widths need to be minimised to suit.



FEATURES & BENEFITS

Manufactured within the UK, our system features:

- Standard section sizes designed to suit particular forklift trucks.
- Standard modular lengths to help build precise layout requirements.
- Options of painted or galvanised finishes.
- Pre-drilled holes, designed to suit a range of suitable floor fixings.
- Fully prepared steel for speedy installation.
- A range of available lead-in components to aid easy entry to aisles.
- Fish plate joints enable easy site assembly.



DESIGN

- Standard low profile rail from 50 x 50 x 8 RSA.
- Standard high profile rail from 100 x 75 x 10 RSA.
- 150 x 75 x 10 & 150 x 75 x 12 RSA also available as standard.



OVERVIEW

Fish plated joints enabling easy site assembly.

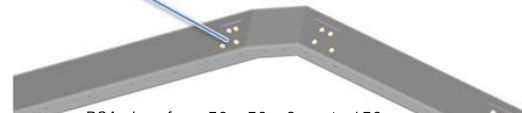

RSA sizes from 50 x 50 x 8mm to 150 x 75 x 12mm to suit truck needs

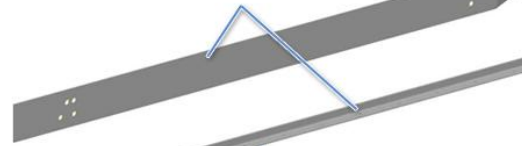

Varying pre-drilled hole centres to suit areas of high impact or regular use



Flared or Radius lead-in styles to suit truck needs

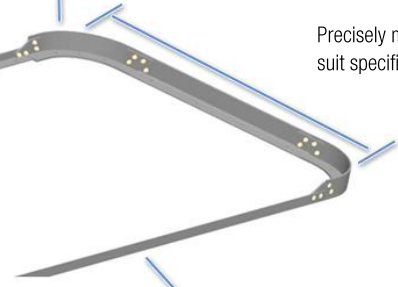

Precisely manufactured to suit specific rack layouts

Supplied in painted Black finish with options of floor fixings included