

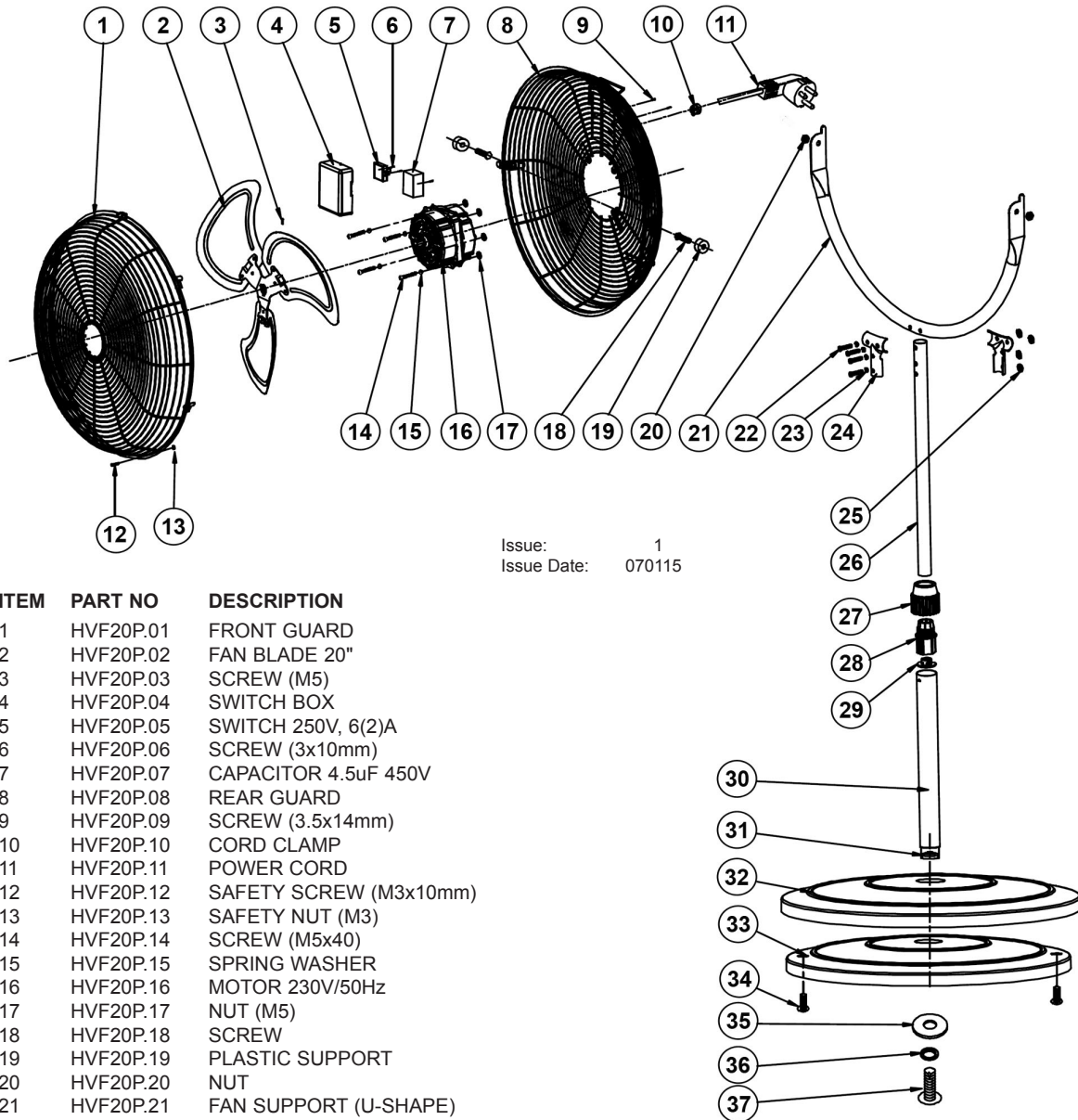

PARTS FOR:
**INDUSTRIAL HIGH VELOCITY
 PEDESTAL FAN 20" 230V**
 MODEL: **HVF20P**



Issue: 1
 Issue Date: 070115

ITEM	PART NO	DESCRIPTION
1	HVF20P.01	FRONT GUARD
2	HVF20P.02	FAN BLADE 20"
3	HVF20P.03	SCREW (M5)
4	HVF20P.04	SWITCH BOX
5	HVF20P.05	SWITCH 250V, 6(2)A
6	HVF20P.06	SCREW (3x10mm)
7	HVF20P.07	CAPACITOR 4.5uF 450V
8	HVF20P.08	REAR GUARD
9	HVF20P.09	SCREW (3.5x14mm)
10	HVF20P.10	CORD CLAMP
11	HVF20P.11	POWER CORD
12	HVF20P.12	SAFETY SCREW (M3x10mm)
13	HVF20P.13	SAFETY NUT (M3)
14	HVF20P.14	SCREW (M5x40)
15	HVF20P.15	SPRING WASHER
16	HVF20P.16	MOTOR 230V/50Hz
17	HVF20P.17	NUT (M5)
18	HVF20P.18	SCREW
19	HVF20P.19	PLASTIC SUPPORT
20	HVF20P.20	NUT
21	HVF20P.21	FAN SUPPORT (U-SHAPE)
22	HVF20P.22	SCREW
23	HVF20P.23	SPRING WASHER
24	HVF20P.24	FIXED CLAMP
25	HVF20P.25	NUT
26	HVF20P.26	UPRIGHT SUPPORT (UPPER)
27	HVF20P.27	SUPPORT COVER (OUTER)
28	HVF20P.28	SUPPORT COVER (INNER)
29	HVF20P.29	BUSHING
30	HVF20P.30	UPRIGHT SUPPORT (LOWER)
31	HVF20P.31	UPRIGHT LOCK
32	HVF20P.32	BASE COVER
33	HVF20P.33	ROUND BASE
34	HVF20P.34	SCREW
35	HVF20P.35	WASHER
36	HVF20P.36	SPRING WASHER
37	HVF20P.37	SCREW

NOTE: It is our policy to continually improve products and as such we reserve the right to alter data, specifications and component parts without prior notice.

IMPORTANT: No liability is accepted for incorrect use of product.

WARRANTY: Guarantee is 12 months from purchase date, proof of which will be required for any claim.

