



INSTRUCTIONS FOR: INDUSTRIAL HIGH VELOCITY OSCILLATING PEDESTAL FAN 20"

MODEL No: **HVF20PO**

Thank you for purchasing a Sealey product. Manufactured to a high standard this product will, if used according to these instructions and properly maintained, give you years of trouble free performance.

IMPORTANT: PLEASE READ THESE INSTRUCTIONS CAREFULLY. NOTE THE SAFE OPERATIONAL REQUIREMENTS, WARNINGS & CAUTIONS. USE THE PRODUCT CORRECTLY AND WITH CARE FOR THE PURPOSE FOR WHICH IT IS INTENDED. FAILURE TO DO SO MAY CAUSE DAMAGE AND/OR PERSONAL INJURY AND WILL INVALIDATE THE WARRANTY. KEEP THESE INSTRUCTIONS SAFE FOR FUTURE USE.

1. SAFETY



Refer to
Instructions

1.1. ELECTRICAL SAFETY

WARNING! It is the responsibility of the owner and the operator to read, understand and comply with the following:

You must check all electrical products, before use, to ensure that they are safe. You must inspect power cables, plugs, sockets and any other connectors for wear or damage. You must ensure that the risk of electric shock is minimised by the installation of appropriate safety devices. A Residual Current Circuit Breaker (RCCB) should be incorporated in the main distribution board. We also recommend that a Residual Current Device (RCD) is used. It is particularly important to use an RCD with portable products that are plugged into a supply which is not protected by an RCCB. If in any doubt consult a qualified electrician. You may obtain a Residual Current Device by contacting your Sealey dealer.

You must also read and understand the following instructions concerning electrical safety.

- 1.1.1. The **Electricity at Work Act 1989** requires that all portable electrical appliances, if used on business premises, are tested by a qualified electrician, using a Portable Appliance Tester (PAT), at least once a year.
 - 1.1.2. The **Health & Safety at Work Act 1974** makes owners of electrical appliances responsible for the safe condition of those appliances and the safety of the appliance operators. **If in any doubt about electrical safety, contact a qualified electrician.**
 - 1.1.3. Ensure that the insulation on all cables and on the appliance is safe before connecting it to the power supply. See 1.1.1. and 1.1.2. and use a Portable Appliance Tester.
 - 1.1.4. Ensure that cables are always protected against short circuit and overload.
 - 1.1.5. Inspect power supply cables and plugs regularly for wear or damage and check all connections to ensure that none is loose.
 - 1.1.6. **Important:** Ensure that the voltage marked on the appliance matches the power supply to be used and that the plug is fitted with the correct fuse - see fuse rating at right.
 - 1.1.7. **DO NOT** pull or carry the appliance by the power cable.
 - 1.1.8. **DO NOT** pull the plug from the socket by the cable.
 - 1.1.9. **DO NOT** use worn or damaged cables, plugs or connectors. Have any faulty item repaired or replaced immediately by a qualified electrician. When a BS 1363/A UK 3 pin plug is damaged, cut the cable just above the plug and **dispose of the plug safely.**
Fit a new plug according to the following instructions (UK only).
 - a) **Connect the GREEN/YELLOW earth wire to the earth terminal 'E'.**
 - b) **Connect the BROWN live wire to the live terminal 'L'.**
 - c) **Connect the BLUE neutral wire to the neutral terminal 'N'.**
 - d) **After wiring, check that there are no bare wires, that all wires have been correctly connected, that the cable outer insulation extends beyond the cable restraint and that the restraint is tight.**
- Double insulated products, which are always marked with this symbol , are fitted with live (brown) and neutral (blue) wires only. To rewire, connect the wires as indicated above - **DO NOT** connect either wire to the earth terminal.
- 1.1.10. Products which require more than 13 amps are supplied without a plug. In this case you must contact a qualified electrician to ensure that a suitably rated supply is available. We recommend that you discuss the installation of an industrial round pin plug and socket with your electrician.
 - 1.1.11. If an extension reel is used it should be unwound fully before connection. A reel with an RCD fitted is preferred since any appliance plugged into it will be protected. The cable core section is important and should be at least 1.5mm², but to be absolutely sure that the capacity of the reel is suitable for this product and for others which may be used in the other output sockets, we recommend the use of 2.5mm² section cable.

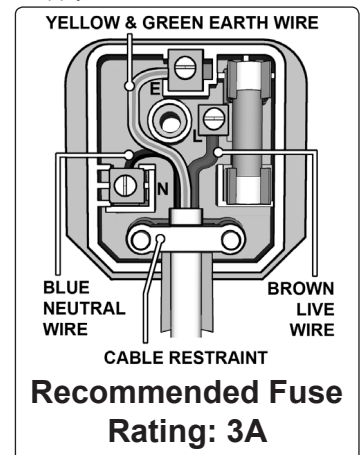

1.2. GENERAL SAFETY

- ✓ Disconnect the fan from the mains power when not in use, and before servicing or performing any maintenance.
- ✓ Use the fan in dry areas only. **DO NOT** use in wet or areas with high condensation such as showers, pools etc.
- ❑ **WARNING!** If the fan falls into water or other liquid, switch off and disconnect from the mains power supply immediately. **DO NOT** touch the fan until the mains power supply has been disconnected.
- ✓ Always disconnect the fan from the power supply when moving it from one location to another and ensure fan stands on a level surface.
- ✓ The fan air flow is powerful. Before using ensure there are no materials or items that may be blown about by the stream of air.
- ✓ Keep the fan clean and maintained in good condition. For electrical components or motor service contact an authorised service agent.
- ✓ Use recommended parts only (unapproved parts may be dangerous, and will invalidate your warranty).
- ✗ **DO NOT** operate the fan where there are harmful, explosive or flammable gases, fumes or hazardous substances.
- ✗ **DO NOT** stand the fan on the electrical power cable.
- ✗ **DO NOT** insert any objects through the fan guard.
- ✗ **DO NOT** cover the fan when in use.
- ✗ **DO NOT** immerse the fan in water or any other liquid.
- ✗ **DO NOT** allow children to operate the fan.
- ✗ **DO NOT** stand the fan where it may be knocked over or off a surface, or where the lead may cause a person to trip.
- ✗ **DO NOT** use the fan outdoors.
- ✗ **DO NOT** modify speed control or attempt to fit any additional external speed control device to the fan.
- ✓ When not in use cover the fan to protect from dust, and store in a safe, dry, childproof location.

2. INTRODUCTION

High velocity fan suitable for movement of huge volumes of air. Features three-speed settings for choice of airflow, height adjustable stand, tilting blade cradle and oscillation. Fully guarded blades with large diameter base for safety and added stability. Suitable for industrial, commercial, agricultural, workshop and showroom applications.

3. SPECIFICATIONS

Model No: **HVF20PO**
Fan Diameter: 550mm(20")
Speeds: 3
Speed Range: 1050/1150/1350rpm
Maximum Airflow: 110m³/min(3900CFM)
Height: 1080-1410mm
Power: 115W
Supply: 230V
Current: 0.5A

4. ASSEMBLY

- 4.1. Bolt the bottom tube to the base as in fig.1.1.
- 4.2. Place the fan head assembly on the upper tube (fig.1.2)
- 4.3. Secure the fan head assembly by means of the two bolts as shown in fig.1.3.
- 4.4. The height is adjustable by loosening the collar on the tube, sliding to the required height and retightening.
- 4.5. The angle of the head is adjusted by loosening the head clamp and moving the head and retightening the clamp.

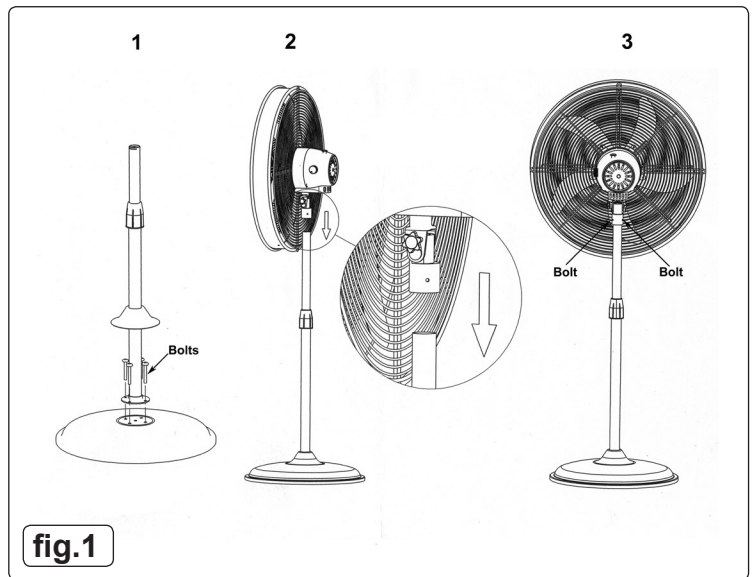

5. OPERATION

IMPORTANT: Ensure that all safety instructions from section 1 have been read and understood before using the fan.

- 5.1. Set the fan on a level, dry surface.
- 5.2. Plug the power cord into the mains supply.
- 5.3. The fan features 3 speeds - selectable using the switch located at the back of the fan (fig.2.1.) The fan speed increases as the switch is turned in a clockwise direction.
- 5.4. To start the fan oscillating, press the control button (fig.2.2.) down, and lift to stop the oscillation.
- 5.5. When not in use, disconnect from power supply and store in a safe, dry, childproof location.

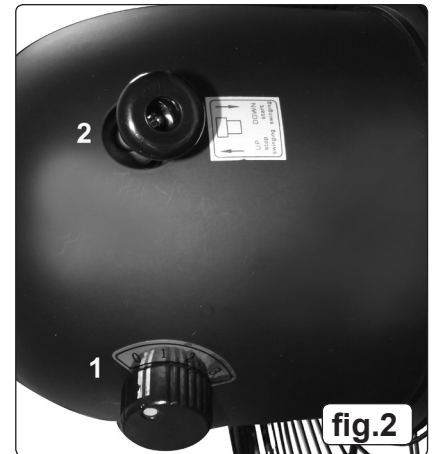

6. CARE

IMPORTANT: Turn the control switch to OFF and disconnect the fan from the power supply before cleaning.

- 6.1. Use only a soft, damp cloth to clean the fan.
- 6.2. **DO NOT** submerge the fan in water and **NEVER** allow water to drip into the motor housing.
- 6.3. **DO NOT** use solvents or other chemicals to clean the fan.
- 6.4. To clean the fan blades, loosen the 7 clips around the guards and then lift off the front guard from the top hook.
- 6.5. Wipe the blades and guards.
- 6.6. Reassemble by hooking the front guard into place at the top of the rear guard and then push the 7 clips back into place so that they engage both the front and rear guards.



WEEE Regulations

Dispose of this product at the end of its working life in compliance with the EU Directive on Waste Electrical and Electronic Equipment (WEEE). When the product is no longer required, it must be disposed of in an environmentally protective way. Contact your local solid waste authority for recycling information.

NOTE: It is our policy to improve products continually and as such we reserve the right to alter data, specifications and component parts without prior notice.

IMPORTANT: No liability is accepted for incorrect use of this product.

