



INSTRUCTIONS FOR:

## INDUSTRIAL DEHUMIDIFIER 70LTR

MODEL NO: **SDH70**

Thank you for purchasing a Sealey product. Manufactured to a high standard, this product will, if used according to these instructions, and properly maintained, give you years of trouble free performance.

**IMPORTANT: PLEASE READ THESE INSTRUCTIONS CAREFULLY. NOTE THE SAFE OPERATIONAL REQUIREMENTS, WARNINGS & CAUTIONS. USE THE PRODUCT CORRECTLY AND WITH CARE FOR THE PURPOSE FOR WHICH IT IS INTENDED. FAILURE TO DO SO MAY CAUSE DAMAGE AND/OR PERSONAL INJURY AND WILL INVALIDATE THE WARRANTY. KEEP THESE INSTRUCTIONS SAFE FOR FUTURE USE.**



Refer to the  
instruction manual

### 1. SAFETY

#### 1.1. ELECTRICAL SAFETY

**WARNING!** It is the responsibility of the owner and the operator to read, understand and comply with the following:

You must check all electrical products, before use, to ensure that they are safe. You must inspect power cables, plugs, sockets and any other connectors for wear or damage. You must ensure that the risk of electric shock is minimised by the installation of appropriate safety devices. A Residual Current Circuit Breaker (RCCB) should be incorporated in the main distribution board. We also recommend that a Residual Current Device (RCD) is used. It is particularly important to use an RCD with portable products that are plugged into a supply which is not protected by an RCCB. If in any doubt consult a qualified electrician. You may obtain a Residual Current Device by contacting your Sealey dealer.

**You must** also read and understand the following instructions concerning electrical safety.

1.1.1. The **Electricity at Work Act 1989** requires that all portable electrical appliances, if used on business premises, are tested by a qualified electrician, using a Portable Appliance Tester (PAT), at least once a year.

1.1.2. The **Health & Safety at Work Act 1974** makes owners of electrical appliances responsible for the safe condition of those appliances and the safety of the appliance operators. **If in any doubt about electrical safety, contact a qualified electrician.**

1.1.3. Ensure that the insulation on all cables and on the appliance is safe before connecting it to the power supply. See 1.1.1. and 1.1.2. and use a Portable Appliance Tester.

1.1.4. Ensure that cables are always protected against short circuit and overload.

1.1.5. Regularly inspect power supply cables and plugs for wear or damage and check all connections to ensure that none is loose.

1.1.6. **Important:** Ensure that the voltage marked on the appliance matches the power supply to be used and that the plug is fitted with the correct fuse - see fuse rating at right.

1.1.7. **DO NOT** pull or carry the appliance by the power cable.

1.1.8. **DO NOT** pull the plug from the socket by the cable.

1.1.9. **DO NOT** use worn or damaged cables, plugs or connectors. Immediately have any faulty item repaired or replaced by a qualified electrician. When a BS 1363/A UK 3 pin plug is damaged, cut the cable just above the plug and **dispose of the plug safely.**

Fit a new plug according to the following instructions (UK only).

a) **Connect the GREEN/YELLOW earth wire to the earth terminal 'E'.**

b) **Connect the BROWN live wire to the live terminal 'L'.**

c) **Connect the BLUE neutral wire to the neutral terminal 'N'.**

d) **After wiring, check that there are no bare wires, that all wires have been correctly connected, that the cable outer insulation extends beyond the cable restraint and that the restraint is tight.**

Double insulated products, which are always marked with this symbol , are fitted with live (brown) and neutral (blue) wires only.

To rewire, connect the wires as indicated above - **DO NOT** connect either wire to the earth terminal.

1.1.10. Products which require more than 13amps are supplied without a plug. In this case you must contact a qualified electrician to ensure that a suitably rated supply is available. We recommend that you discuss the installation of an industrial round pin plug and socket with your electrician.

1.1.11. If an extension reel is used it should be fully unwound before connection. A reel with an RCD fitted is preferred since any appliance plugged into it will be protected. The cable core section is important and should be at least 1.5mm<sup>2</sup>, but to be absolutely sure that the capacity of the reel is suitable for this product and for others which may be used in the other output sockets, we recommend the use of 2.5mm<sup>2</sup> section cable. If an extension reel is to be used outdoors, ensure it is marked for outdoor use.

#### 1.2. GENERAL SAFETY

✓ Check that the dehumidifier is in sound condition and good working order. *Take immediate action to repair or replace damaged parts.*

✓ Use recommended parts only. *Unauthorised parts may be dangerous and will invalidate the warranty.*

X **DO NOT** stand or place any object less than 10cm from the front or rear of the unit.

X **DO NOT** obstruct the air intakes or outlets of the dehumidifier.

X **DO NOT** place any object into the outlets - the unit has a fan running at high speed, contact with this will cause injury.

X **DO NOT** operate the dehumidifier when you are tired or under the influence of alcohol, drugs or intoxicating medication.

X **DO NOT** switch the dehumidifier off by disconnecting it from the mains. **ALWAYS** switch to the "OFF" position first.

X **DO NOT** remove the float lever from the water collection tank.

X **DO NOT** connect or disconnect the plug from the mains with wet hands.

✓ Always discard the water from the collection tank, **DO NOT** use it for any other purpose.

✓ Place the dehumidifier on a level and stable surface.

✓ **DO NOT** use the dehumidifier at ambient temperatures below 5°C.

✓ **DO NOT** use the dehumidifier outside.

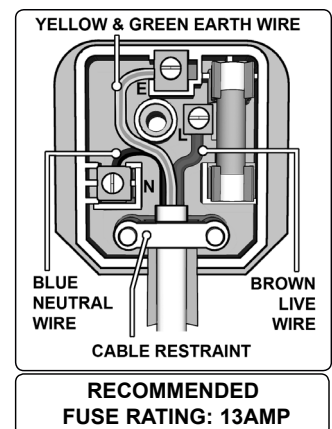

- ✓ When using continuous draining, make sure that the drain hose is positioned correctly.
  - ✓ Ensure that heating appliances are not exposed to the flow of air from the dehumidifier.
  - ✓ Before attempting to move the dehumidifier, empty the contents of the collection tank.
  - ✓ Switch off and disconnect it from the mains before attempting any cleaning or other maintenance work.
  - ✓ Ensure that the dehumidifier is correctly turned off when not in use, and stored in a safe, dry area, out of reach of children.
  - ☐ **WARNING! The warnings, cautions and instructions in this manual cannot cover all possible conditions and situations that may occur. It must be understood by the operator that common sense and caution are factors which cannot be built into this product, but must be applied by the operator.**
- NOTE:** This appliance can be used by children aged from 8 years and above and persons with reduced physical, sensory or mental capabilities or lack of experience and knowledge if they have been given supervision or instruction concerning use of the appliance in a safe way and understand the hazards involved. Children shall not play with the appliance. Cleaning and user maintenance shall not be made by children without supervision.

## 2. INTRODUCTION

Powerful dehumidification capacity. Removes excess moisture from air, preventing build-up of mildew and mould. Features auto-defrost function, which activates if the room temperature falls too low. Washable activated carbon air filter. Refrigerant is R407C. May be connected to a drain hose for continuous operation. Mounted on castors for manoeuvrability.

## 3. SPECIFICATION

Model No:.....	SDH70
Supply:.....	230V
Power:.....	1360W
Dehumidifier Capacity:.....	70ltr/day
Maximum Airflow:.....	800m <sup>3</sup> /hr
Refrigerant:.....	R407C
Condensate Tank:.....	5.8ltr (with auto shut off)
Working Temperature Range:.....	5° - 32°C
Dimensions (L x W x H):.....	497 x 420 x 850mm
Weight:.....	44kg

## 4. OPERATION

Air from the room is drawn through the dehumidifier by a fan, this air is filtered capturing airborne dust. Moisture in the air condenses on the cooling coils falling as droplets into a drip tray and internal or external water tank. Efficiency of the dehumidifier is influenced by the air outside the room. For operating efficiently, avoid opening and closing the windows and doors. For best performance, operate the dehumidifier within the usable operating temperature.

### 4.1. Operation

- 4.1.1. Plug the unit in to the mains socket, a beep will be heard when inserting the plug.
- 4.1.2. Press the "ON/OFF" switch and the operation light will illuminate, the humidity display will light to display the previous set humidity. The initial setting for humidity is 60%, after 3 seconds the display will show the current humidity.
- 4.1.3. Press the humidity up or down buttons to adjust to the desired humidity required. If the required humidity is 3% below the current humidity the unit will start automatically, if the set humidity is 3% more than the current humidity the dehumidifier will automatically stop.
- 4.1.4. The unit has a memory function. Use the humidity up and down buttons to adjust to the desired setting and then press the memory button to record the setting, each time the machine is switched on it will automatically run at the required setting.
- 4.1.5. When setting the humidity to less than 30%, the unit will run continuously and the display will read "CO".
- 4.1.6. To shut the dehumidifier down press the "ON/OFF" switch.

**Note:** If the humidity setting is greater than the current humidity the unit will not run.

- ☐ **WARNING!** The fan motor and compressor must run for at least 3 minutes while dehumidifying.
- x **DO NOT** start the dehumidifier immediately after shutting down, allow 3 minutes before restarting.

fig.1



fig.2



Control Panel

## 4.2. Defrosting Operation

The evaporator within the dehumidifier frosts during the dehumidifying operation at a room temperature of approximately 15°C or less. The defrosting device works automatically at an interval of approximately every 30 minutes for a duration of approximately 5 minutes. The dehumidifying function will stop during the defrosting operation. **DO NOT** disconnect the plug or turn off the unit during the defrosting operation.

**Note:** This dehumidifier does not have a cooling function, it produces heat during operation and the room temperature will rise by 1°C to 4°C. The temperature increases while it is operated in a closet, or similar. The temperature will rise because doors and windows are closed and heat is produced from other appliances in the room and from sun radiation. Furthermore, a drier environment is less expensive to heat.

## 4.3. Emptying the Water Collection Tank

During the dehumidifying operation, water is collected in the water collection tank. When the tank is full of water, the dehumidifier stops operating automatically and the warning buzzer beeps twice. The unit will not restart until the water collection tank has been emptied.

- 4.3.1. Open the dehumidifier door and remove the hose from the water collection tank. Then remove the tank (fig.3).
- 4.3.2. Hold the tank by the handle and carry it carefully to an emptying point.
- 4.3.3. Empty the water out of the tank.
- 4.3.4. Replace the tank in the dehumidifier, making sure it is properly back in place; the unit will not restart if it is not fitted correctly.
- 4.3.5. Insert the drain hose into the tank.

## 4.4. Continuous Draining

- 4.4.1. If there is a place suitable for draining, continuous draining can be carried out. The continuous operation enables the dehumidifying operation to continue uninterrupted.
- 4.4.2. Turn off the dehumidifier, disconnect the power plug and remove the water collection tank.
- 4.4.3. Attach the short length of hose to the plastic bulkhead fitted to the casing, secure with a hose clip. See fig.3 bottom left.
- 4.4.4. Attach a suitable length of hose; it should have an inner diameter of 16mm (5/8"), secure with a hose clip. See fig.3 bottom right.
- 4.4.5. Replace the tank in the dehumidifier, making sure it is properly back in place; the unit will not restart if it is not fitted correctly.
- 4.4.6. Continue to use the dehumidifier as normal.

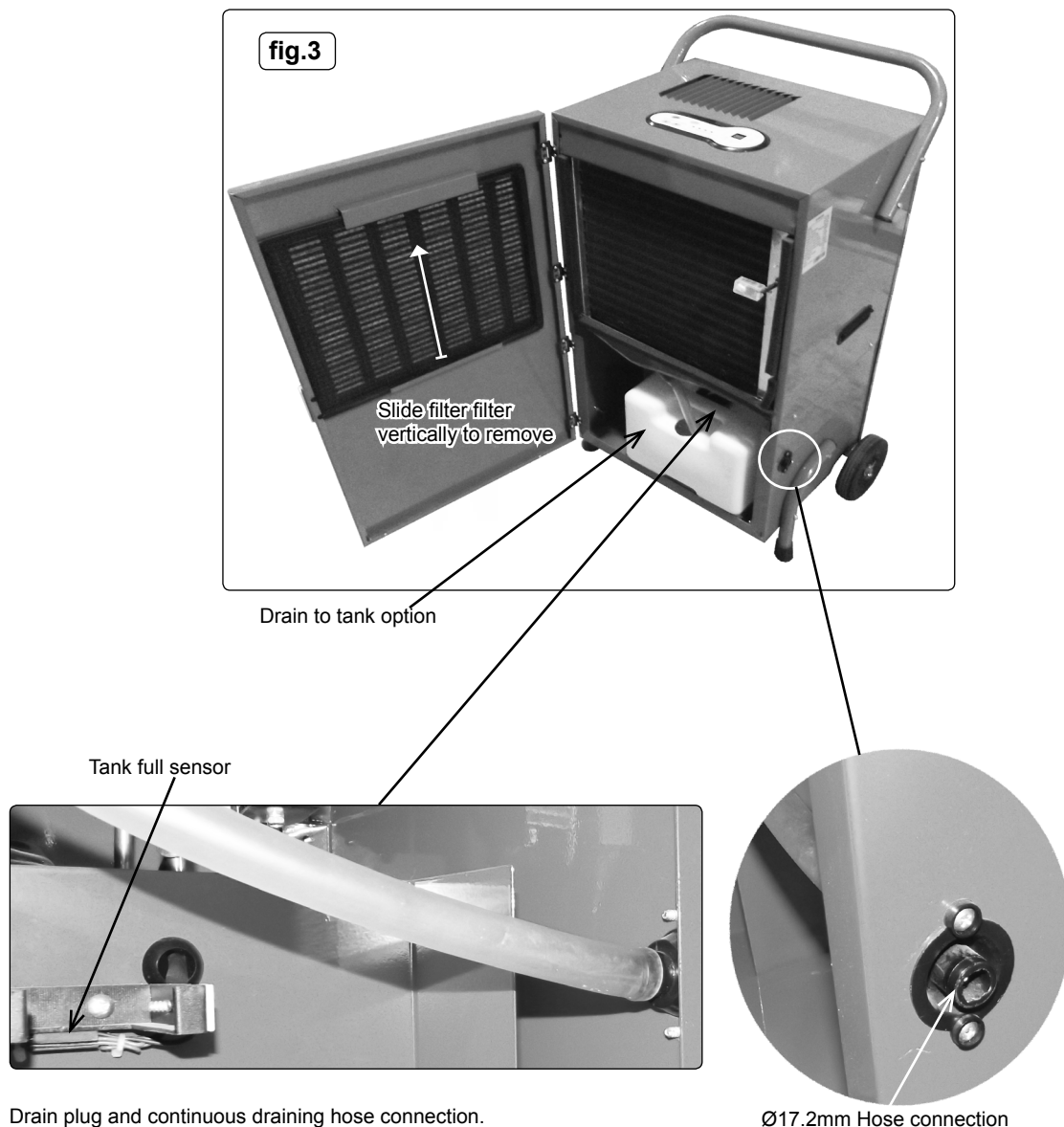

## 5. MAINTENANCE

### 5.1. Cleaning Air Filter

The dehumidifying capacity is lowered when the air cleaning filter becomes clogged.

- 5.1.1. Open the front door of the unit.
- 5.1.2. Lift up the filter element from the bottom as shown in fig.3 and lift out of the holder.
- 5.1.3. To dislodge the dust from the filter, use a vacuum cleaner or tap it lightly.
- 5.1.4. If the filter is very dirty, wash it carefully in water with a neutral detergent, then rinse well with clean water and leave until dry.
- 5.1.5. To refit the air filter, locate the top of the element into the locating bracket at the top of the door and then locate the lower section into the lower bracket.
- 5.1.6. Close the door of the dehumidifier.

### 5.2. Storage

- 5.2.1. Unplug the unit, bundle the power cord, and hang the bundled cord at the back of the unit.
- 5.2.2. Remove the water collection tank and empty the water out of it. Wash the inside of the tank with clean water. **DO NOT** remove the float lever from the tank. Wipe off the water on the outside of the tank with a cloth. Replace the tank in position.
- 5.2.3. Clean the air filter (see 4.1).
- 5.2.4. When the unit is to be stored for a long time, wipe the dehumidifier over with a dry soft cloth. To remove dirt, wipe over with a very slightly dampened cloth (never use a wet cloth for cleaning the controls). To avoid deformation or cracking, do not use benzene, thinner or liquid cleaners.
- 5.2.5. When storing, place in a safe, dry, childproof location. Stand the unit upright and avoid exposure to direct sunlight.

## 6. TROUBLESHOOTING

Error Codes	Problem
E1	Humidity sensor faulty
E2	Refrigerant sensor faulty

Problem	Cause	Remedy
Will not run	Switch is not "ON"	Switch "ON"
	Unit is not plugged in	Insert plug
	Fuse blown	Replace fuse
	Water tank full	Empty water tank
Dehumidifier inefficient	Filter blocked	Clean filter
	Inlet or outlet vents restricted	Remove restriction
	Doors or windows open	Close openings
	Refrigerant leak	Contact Sealey dealer
Water leaking from unit	Dehumidifier is not level	Adjust position of dehumidifier
	Tank float not shutting down unit	Contact Sealey dealer

### Environmental Protection



Recycle unwanted materials instead of disposing of them as waste. All tools, accessories and packaging should be sorted, taken to a recycling centre and disposed of in a manner which is compatible with the environment. When the product becomes completely unserviceable and requires disposal, drain off any fluids (if applicable) into approved containers and dispose of the product and the fluids according to local regulations.



### WEEE Regulations

Dispose of this product at the end of its working life in compliance with the EU Directive on Waste Electrical and Electronic Equipment (WEEE). When the product is no longer required, it must be disposed of in an environmentally protective way. Contact your local solid waste authority for recycling information.

**NOTE:** It is our policy to continually improve products and as such we reserve the right to alter data, specifications and component parts without prior notice.

**IMPORTANT:** No liability is accepted for incorrect use of this product.

**WARRANTY:** Guarantee is 12 months from purchase date, proof of which will be required for any claim.

