

Thank you for purchasing a Sealey product. Manufactured to a high standard this product will, if used according to these instructions and properly maintained, give you years of trouble free performance.



**IMPORTANT: PLEASE READ THESE INSTRUCTIONS CAREFULLY. NOTE THE SAFE OPERATIONAL REQUIREMENTS, WARNINGS & CAUTIONS. USE THE PRODUCT CORRECTLY AND WITH CARE FOR THE PURPOSE FOR WHICH IT IS INTENDED. FAILURE TO DO SO MAY CAUSE DAMAGE AND/OR PERSONAL INJURY AND WILL INVALIDATE THE WARRANTY. PLEASE KEEP INSTRUCTIONS SAFE FOR FUTURE USE.**

## 1. SAFETY INSTRUCTIONS

- ✓ Always load evenly with the centre of gravity of the load as near the centre and rear of the plate as possible.
- ✓ Obtain additional support for large or wide loads to prevent tipping.
- x **DO NOT** overload the truck - see Specification.
- x **DO NOT** leave unattended, especially when loaded, unless the wheels are chocked or the truck is otherwise secured.
- x **DO NOT** use truck on uneven ground and **DO NOT** run over curbs or steps - use a ramp.
- x **DO NOT** allow others to ride on the truck.
- x **DO NOT** use the truck if any part is damaged, paying particular attention to the wheels.

## 2. SPECIFICATION

Model No: .....CST988.V3  
 Max. Load:.....250kg  
 Wheel Diameter:..... 250mm  
 Wheel Thickness: ..... 90mm  
 Height: ..... 1260mm  
 Overall Width:..... 560mm  
 Platform Depth: ..... 220mm

## 3. FEATURES

- 3.1 CST988.V3 is a case carrying model with a high back and flat loading capabilities.

## 4. ASSEMBLY

- 4.1 **Wheels** Ensure axle is clean from dust and dirt to allow free movement of the wheel.  
 4.2 The axle (1.1) needs to be put through the frame before the wheels can be attached.  
 4.3 Slide the wheel (1.2) onto the axle, put on the washer (1.3) and complete by pushing the split pin (1.4) through the hole in the end of the axle and bending over to retain.  
 4.4 Repeat for the other side.

fig 1

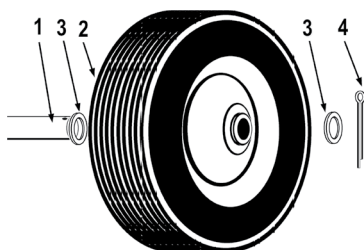

**Parts support is available for this product. To obtain a parts listing and/or diagram, please log on to [www.sealey.co.uk](http://www.sealey.co.uk), email [sales@sealey.co.uk](mailto:sales@sealey.co.uk) or phone 01284 757500.**

**NOTE:** It is our policy to continually improve products and as such we reserve the right to alter data, specifications and component parts without prior notice.

**IMPORTANT:** No liability is accepted for incorrect use of this product.

**WARRANTY:** Guarantee is 12 months from purchase date, proof of which will be required for any claim.

**INFORMATION:** For a copy of our latest catalogue and promotions call us on 01284 757525 and leave your full name and address, including postcode.